



TECHNICAL DATA & INFORMATION

Jack H. Skirball Center for the Performing Arts

Tel. 212.992.8484



TECHNICAL DATA & INFORMATION

Jack H. Skirball Center for the Performing Arts

TABLE OF CONTENTS

GENERAL INFORMATION	03
CONTACTS	04
FACILITY	05
LOADING IN, TRUCK PARKING AND PERMITS	06
CARPENTRY	07
LIGHTING	10
SOUND	13
AUDIO VISUAL	15
STAGE FURNISHINGS AND WARDROBE	16
DRESSING ROOM LAYOUT AND SEATING CHART	17
NEIGHBORHOOD INFO: HOTELS, RESTAURANTS, STORES, ETC.	18
MAPS	25

TECHNICAL DATA & INFORMATION

Jack H. Skirball Center for the Performing Arts

GENERAL INFORMATION

MAILING ADDRESS

Jack H. Skirball Center for the Performing Arts
Administrative Offices
60 Washington Square South, Suite 503
New York, NY 10012

THEATER ADDRESS AND AUDIENCE ENTRANCE

566 LaGuardia Place
at Washington Square
New York, NY 10012

STAGE DOOR (AT SPECIFIED CALL TIMES ONLY)

566A LaGuardia Place at West 3rd Street

LOADING DOCK (BY APPOINTMENT ONLY)

West 3rd Street between LaGuardia Place and Thompson Street

HANDICAPPED ACCESS

18 wheel chair / disability seating locations available, accessible through theater entrance and building entrance. Wheel chair access to stage through stage door or building entrance. Infrared Listening Devices available upon request.

BUILDING ENTRANCE (24HRS)

The main entrance to the Kimmel Center for University Life is on Washington Square South between LaGuardia Place and Thompson Street; across the street from Washington Square Park

There is no public access to the Skirball Center from this entrance.

TECHNICAL DATA & INFORMATION

Jack H. Skirball Center for the Performing Arts

CONTACTS

SENIOR DIRECTOR

Michael Harrington
212.998.2346
michael.harrington@nyu.edu

ASSISTANT DIRECTOR, MARKETING AND COMMUNICATION

Donald Webster
212.992.8499
donald.webster@nyu.edu

BUSINESS MANAGER

Liz Olson
212.992.
liz.olson@nyu.edu

PRODUCTION MANAGER

Jason Adams
212.992.8497
jason.adams@nyu.edu

TECHNICAL CREW HEADS

Lighting: Jeff Collier, jeffrey.collier@nyu.edu
Audio: Ethan Bade, ethan.bade@nyu.edu
Stage: Erik Fulk, erik.fulk@nyu.edu
Production Office: 212.992.8497

EMERGENCIES

NYU Public Safety Emergency: 212.998.2222

All Emergencies: 911
Fire Department: Patrol 2 3rd St & Thompson
Police Department: 6th Precinct West 10th St

OPERATIONS DIRECTOR

Amy Coombs
212.992.8486
amy.coombs@nyu.edu

DEVELOPMENT COMMUNICATIONS MANAGER

Kimberly Olstad
212.992.8482
kimberly.olstad@nyu.edu

FRONT OF HOUSE MANAGER

Ian Tabatchnick
212.992.8480
itabatch@nyu.edu

ADMINISTRATIVE COORDINATOR

Barbara Espinoza
212.992.8487
barbara.espinoza@nyu.edu

TICKETING SERVICES

Ellen L. Holt, Manager
212.992.8474
lori.moore@nyu.edu

Jason Stuart
Assistant Box Office Manager
212.992.8474
jcs10@nyu.edu

OTHER

Back Stage: 212.992.8493
Greenroom: 212.992.8492

Kimmel Center Security Desk: 212.998.1319
Top of the Square Catering: 212.998.4690
NYU Information Hotline: 212.998.1220

TECHNICAL DATA & INFORMATION

Jack H. Skirball Center for the Performing Arts

FACILITY

SEATING

Total Capacity: 870

Balcony: 179

Parterre: 169

Orchestra: 453

Orchestra Pit: 62

Wheelchair: 7

DRESSING ROOMS

A: 15' 7.5" x 14' 6" 3 mirror stations, 2 sinks, 1 shower, 1 toilet

B: 20' 10" x 14' 6" 6 mirror stations, 2 sinks, 1 shower, 1 toilet

C: 21' 10" x 14' 6" 7 mirror stations, 4 sinks, 1 shower, 1 toilet

REHEARSAL ROOM

Dimensions: 49' 6" x 30' 7" x 7' 9"

GREENROOM

Dimensions: 30' x 14' 6"

Resources: refrigerator, microwave, conference table with seating for 8

INTERNET CONNECTIVITY

The Skirball Center is equipped with password protected Wi-Fi internet access. Contact a Skirball Center staff member upon arrival for the username and password.

STAGE MANAGER'S POSITION

Rear of parterre, house left booth.

Backstage both left and right.

Projection Booth rear of house

TECH TABLES

1 - 8' x 4'

2 - 4' x 4'

SOUND MIX POSITION

Last row of Parterre house left.

STORAGE/DELIVERIES

Storage space is minimal and only available during contracted time in the space. Please discuss needs well in advance.

No deliveries are possible in advance of load in.

TECHNICAL DATA & INFORMATION

Jack H. Skirball Center for the Performing Arts

LOADING IN, TRUCK PARKING AND PERMITS

LOADING DOCK

The loading dock is located on West 3rd Street. It accommodates 3 trucks or 2 trucks & 1 dumpster. Load in time needs to be scheduled in advance. Dock is shared with the Kimmel Center, trucks may not be parked when loading and unloading is not in progress. Trucks over 22 ft. require "No Parking" arrangements on the south side of West 3rd Street.

Dimensions of Main Bay: 32' 8" x 12' 1" x 2' 9"

Dimensions of Upstage Loading Door: 10' 4" high x 12' wide

FREIGHT ELEVATOR

Dimensions: 12' long x 10' high x 5' 10" wide

TRUCK PARKING GARAGES

Park Right Corp.
600 11th Ave
New York, NY 10036
212.262.4771

Parkright.com
Wooster
6 Wooster St.
New York, NY 10013
347.219.7259
info@woosterparking.com

PARKING PERMITS AND FILM PERMITS

With the NYU Department of Public Safety, the Skirball Center can post "No Parking" signs on LaGuardia Place on the day of your event if requested. These signs are posted as a courtesy and do not bear enforcement from the New York Police Department. Official permits and signage must be secured from the New York City Mayor's Office listed below.

An official Motion-Picture Television Permit is required for film shoots asserting use on City property or required parking of trucks or vehicles in a non-authorized location. Forms, fees and more information can be found at:

Parking and Film Permits, City of New York Web www.nyc.gov/film
Mayor's Office of Film, Theater and Broadcasting Phone 212.489.6710
1697 Broadway, NY, NY 10019 Fax 212.262.7677

TECHNICAL DATA & INFORMATION

Jack H. Skirball Center for the Performing Arts

CARPENTRY

STAGE DIMENSIONS

Proscenium: Width: 68' (45' 9" inside of Proscenium Columns)
Height: 32' to canopy

Width: Wall to Wall: 82' 4"
Wall to Rail: 78' 4"
Wall to Fly Bridge: 70' 4"

Height: (Roof Steel)
Stage Deck to Bottom of Steel 39' 4"

Stage Depth: 29' 6" from plaster to upstage wall
46' 2" from downstage edge to up stage wall

Apron Depth: 7' at centerline

Grid Height: Under hung Grid 39' 4" above deck

Orchestra Pit: 43' 7" wide x 18' 9" deep = 774 sq. ft.
Height is adjustable.
Maximum depth of 6' below floor of the house.

Stage Height from Audience Floor: 3' 5"

STAGE FLOOR

Surface: Cherry Wood Sprung Floor
No nailing, screwing, or stapling allowed.
Tape usage must be approved in advance

Black Harlequin Cascade Dance Floor available
Full stage
No rosin permitted.

TECHNICAL DATA & INFORMATION

Jack H. Skirball Center for the Performing Arts

CARPENTRY cont.

HOUSE DRAPERIES

- Main Curtain: 1 Velour, bottom weight, 75% Fullness, Color: Jezebel (red)
Height: 32' 9"
Width: 39'
- Valence: 2 adjustable panels:
Panel #1—1 Velour, Unlined, bottom pipe, Flat, Color: Black
Height: 9' 6"
Width: 73' 6"
Panel #2—1 Velour, Unlined, bottom pipe, Flat, Color: Black
Height: 8'
Width: 73' 6"
- Tormentor Panels: 4 Adjustable panels, Velour, at furthest off stage 42', Flat, Color: Black
Pin into the floor
Height: 31' 8"
Width: 7'
- Legs: 4 Velour, Unlined, bottom weight, Flat, Color: Black
Height: 32' 9"
Width: 10' 10"
- Borders: 4 Velour, Unlined, bottom weight, Flat, Color: Black
Height: 10' 10"
Width: 63'
- Travellers: 2 Velour, Unlined, bottom weight, 50% Fullness, Color: Black
Height: 32' 9"
Width: 34' 6"
- Scrim: 1 Sharkstooth, bottom pipe, Color: White
1 Sharkstooth, bottom pipe, Color: Black
Height: 25'
Width: 63'
- Cyc: 1 Seamless Muslin, bottom pipe, Color: White
Height: 25'
Width: 63'
- Bounce: 1 Natural Seamed Muslin, bottom pipe
Height: 25'
Width: 63'
- Other: 2 column sleeves, color: Black

TECHNICAL DATA & INFORMATION

Jack H. Skirball Center for the Performing Arts

CARPENTRY cont.

LINE SET SCHEDULE

Working Height

of Battens: 4'

Gridded Height

of Battens: 35' 6"

Battens: 63' long, 1850 lb spread evenly

Type: Single Purchase

Arbor Capacity: 12' Arbor

Available Wt.: 18,000 lb: 28 lb bricks + 14 lb bricks

Loading Gallery: 3 elevated levels for loading

Pin Rail: None. Lock Rail is elevated above dock

CROSSOVER

Main crossover through dressing room hallway. On stage crossover upstage of black traveller, if cyc is not used.

SCENE SHOP

No scene shop exists. Please discuss what building, if any, can take place on site.

TECHNICAL DATA & INFORMATION

Jack H. Skirball Center for the Performing Arts

LIGHTING

DIMMERS

- (288) 2.4k Strand SLD Digital Dimmers for stage use.
- (24) 2.4k ETC Sensor Dimmers located in Fly Pit. Cable runs to locations as needed.
- (96) 2.4k Strand SLD Digital Dimmers for House, Lobby, Work Lights.

CONTROL BOARD

The light board is an ETC EOS Console
Control channels: 5000 +
(23 scene snapshot backup for one universe of DMX)
Network Node
(2) Flat screen monitors for Tech Table

Multiple DMX “dry lines” connect patch panel in booth to lighting positions and theatre locations.
Strand Network connections at Light Booth, Tech Table, Stage Left.

HOUSE LIGHTING

Control via Strand Premier Architectural stations, or as channels on main light board.

CIRCUITS

288 Dimmer per circuit. Stage pin connectors. Please refer to circuit plot.

208V CIRCUITS

Twist lock. (2) per electric, (4) at catwalks, (1) at back wall.

TECHNICAL DATA & INFORMATION

Jack H. Skirball Center for the Performing Arts

LIGHTING cont.

INSTRUMENT INVENTORY

Note that units listed as spare are stored in the lighting shop, and units in the Rep Hang are in position as per the light plot.

Units in Rep Hang:

- Source Four 19deg. 750w - 35
- Source Four 26deg. 750w - 55
- Source Four 36deg. 750w - 78
- Source Four Par WFL 750w - 48
- Selador Vivid R series 63" model with 20degree horizontal and 60degree vertical lenses – 18
(9 permanently installed on the 5E and 9 for the Groundrow)

Spare Units:

- Source Four 10deg. 750w - 4
- Source Four 19deg. 750w - 27
- Source Four 26deg. 750w - 23
- Source Four 36deg. 750w - 14
- Source Four 50deg. 750w - 10
- Source Four 15-30deg. Zoom 750w - 5
- Source Four 25-50deg. Zoom 750w - 5
- Source Four Par 750w - 4
- Selador Vivid R series 63" – 2

Additional Inventory:

- Source Four Bodies - 7
- 19deg Barrel - 2
- 26deg Barrel - 4
- 36deg Barrel - 2
- 50deg Barrel – 2
- S4 PAR WFL, MFL, NSP, and VNSP Lenses - 52

FOLLOW SPOTS

- (2) 1.6kW Strong Xenon Super Trouper Short Throw
- (2) 750w ETC Source Four 10deg. w/handle and iris

BOOMS

NOT ALWAYS INSTALLED. AVAILABLE ON REQUEST.

- (10) 10' Booms.
- (6) 3' 5' Adjustable Rover Stands.

Please see plot for instrumentation

TECHNICAL DATA & INFORMATION

Jack H. Skirball Center for the Performing Arts

LIGHTING cont.

CYC

ALL UPSTAGE SOFTGOODS ARE DEAD-HUNG.

Upstage soft goods consist of :

(1) Seamed muslin bounce drop

(1) Seamless white muslin cyc

(1) Black scrim (white scrim available)

Selador Vivid R Series units on dead hung 5th electric.

Selador Vivid R Series ground row. NOT ALWAYS INSTALLED.

CABLE

Large supply of 5', 10', 25', 50', 100' 2P&G stage cable and two-fers.

POWER

(2) 400 Amp 3-Phase Company Switches Stage Left

(one switch permanently powers portable dimmers)

House dimmer racks are permanently installed.

All company switches have lug terminals—no Cam-Loks.

Other company switch at upstage & box office hallway

STREET CABLE ACCESS

Removable plates at LaGuardia Place allow cable pass-throughs into building, to be distributed to multiple locations in house, booths and catwalks.

TECHNICAL DATA & INFORMATION

Jack H. Skirball Center for the Performing Arts

LINESSET SCHEDULE

LS	Rep Hang	Distance from Plaster line
28	Bounce	28' 2"
27	#5 Electric (cyc units)	27' 5"
26	Cyc	25' 6"
25	Scrim	24' 3"
24	US Traveler	20' 3"
23	#4 Electric	19' 7"
22		18' 11"
21	Border #4	18' 3"
20		17' 7"
19		16' 11"
18	Leg #2	16' 3"
17	#3 Electric	15' 7"
16	Border #3	14' 11"
15		13' 2"
14		12' 6"
13		11' 10"
12	Leg #1	11' 2"
11	#2 Electric	10' 7"
10		9' 10"
9	Border #2	9' 2"
8		8' 6"
7	Screen	8' 0"
6	DS Traveler	6' 7"
5		6' 2"
4		5' 6"
3	#1 Electric	4' 10"
2	Border #1	4' 2"
1		2' 6"
HC	House Curtain	1' 11"
P2	Tormentor	1' 4"
P1	Tormentor	1' 0"
V2	Valance	0' 8"
V1	Valance	0' 3"

*Grey linesets are dead hung

TECHNICAL DATA & INFORMATION

Jack H. Skirball Center for the Performing Arts

SOUND

MONITOR/PAGING

Paging to Backstage Hallway and Dressing Rooms available.
Program feed to Dressing Rooms, Public Areas and Lobby.

ASSISTED LISTENING DEVICES

Sennheiser HC230 Infrared System
38 headsets available for checkout through House Management

CLEARCOM

Clear Com SB440 - 4 channel base station
Single channel and Two channel belt packs with headsets to support
all basic positions: Audio, lighting, SL, SR, Spots, Video, Etc.
Additional headsets available, check for availability.

MIXING CONSOLES

Yamaha PM5D-RH version 2
Also available: Soundcraft K3- 40 Input/ 8 Aux/ 8 Groups/ 4 Matrix. Please inquire about availability.

FIXED SPEAKERS

3 D&B C7 Center Cluster
4 EV QRX 112/75 L/R Upper/Lower Proscenium
2 EV QRX 215/75 L/R Mid-Proscenium
2 EV Xi-1191 Subs
5 D&B E3 Front Fills
5 D&B E3 Under Balcony Delay
4 D&B E3 Balcony Delay

House audio system is fed with single L/R outputs, processed and delayed via a Yamaha DME64.
System is capable of producing peaks at 105 dB (A-weighted) at front of house.

MONITOR WEDGES

8 JBL SRX Monitors with EQs and amplifiers to support
*Soundcraft K3 available to use as monitor console. Please inquire about availability.

TECHNICAL DATA & INFORMATION

Jack H. Skirball Center for the Performing Arts

SOUND cont.

MICROPHONES & DI BOXES

3 Sennheiser - MD421	1 Shure Beta 52
4 Shure – KSM 141	1 Shure Beta 87
2 Countryman Podium Mics	4 Crown PCC-160 Floor Mics
8 Shure - SM58	2 Shure KSM32
2 Neumann - KM184	4 Countryman Isomax to XLR
2 Neumann - KMS105	1 AMT M40
10 Shure – SM57 Dynamic	
4 Shure Beta 57	4 Countryman DI 85 Direct Box
3 Sennheiser E604	4 BSS AR133 Direct Box

*Microphone availability subject to change.

WIRELESS SYSTEM

- 8 Channels Sennheiser Evolution Wireless Receivers
- 8 Sennheiser Evolution Wireless Belt pack Transmitters with Countryman B3 lavalieres
- 8 Sennheiser Evolution Wireless SKM 545 Super Cardioid Handheld Transmitters

Please Note: Either belt packs or handheld transmitters can be used with receivers, mix and match up to 8 channels.

PLAYBACK

- 2 Denon DN-C635 CD Player
- 1 Denon DN-T620 CD/Cassette Tape Combo
- 1 Denon DA-40 DAT Recorder

SIGNAL PROCESSORS

Available to use, but not housed at FOH:

- 5 Klark Teknik DN 360
- 4 DBX 160A compressors
- 5 DBX 1066A gate/compressors
- 2 Lexicon MPX-1

CABLE/PATCHING

Ample single XLR, XLR sub snakes, and NL4 cables in varying lengths for most production's needs.

House has a permanent patch system with lines run to various panels all around the theater, including Down and Up Stage Right, Down and Up Stage Left, throughout catwalks, etc.

TECHNICAL DATA & INFORMATION

Jack H. Skirball Center for the Performing Arts

AUDIO VISUAL

PROJECTION

- Christie HD10K-M
- 2 Barco DCS200 Switchers
- 1 2.5-4.0 Zoom Lens
- 1 15' x 25' Front Projection Screen
- 2 LCD Monitors (1 SL +1 SR) with live video feed from front of house
- 1 FSR CO-2001 video switcher with 7 inputs – Spare, not installed in Rep system

PLAYBACK DECKS

- 2 Sony BDP S370 Blu Ray Players
- 4 Access Points for VGA presentation

DISTRIBUTION

There is an AV backbone which allows the routing of video and audio signal to various locations in the Kimmel Center including the Eisner- Lubin Auditorium (400+ Seats) for simulcast. There is a multi-mode fiber line which allows signal to be sent out of the building to a panel on LaGuardia Place for connection to a satellite truck. Signal may also be routed onto the NYU campus network for transmission on NYU TV and/or web cast. Verizon fiber is suitable for live broadcast.

TECHNICAL DATA & INFORMATION

Jack H. Skirball Center for the Performing Arts

STAGE FURNISHINGS AND WARDROBE

WARDROBE

Dimensions: 11' 6.5" x 12' 4.5"

Resources: Iron, Ironing Board, and Steamer
Whirlpool Washer Extra Large Capacity: LER5636LQ,
Whirlpool Dryer: LXR5432KQ,
3 Racks

CHAIRS

90 black, 10 grey

STANDS

57 Wenger Rough Neck

STOOLS

8 wood, 2 black

STAND LIGHTS

50 40-watt

CONDUCTOR'S PODIUM

Wenger Stand
Podium

PLATFORMS

Wenger Versa Deck
19 4' x 8' Black Platform Top
10 8" legs
10 16" legs
5 24" legs

DANCE FLOOR

Black Harlequin Cascade Dance Floor
Full stage
No rosin permitted.

LECTERN

Height : 46.5"
Width : 32"

PIANO

Steinway Model B 7' x 5'
Yamaha Upright
(Tunings arranged by NYU)

TECHNICAL DATA & INFORMATION

Jack H. Skirball Center for the Performing Arts

DRESSING ROOM LAYOUT

NOT DRAWN TO SCALE

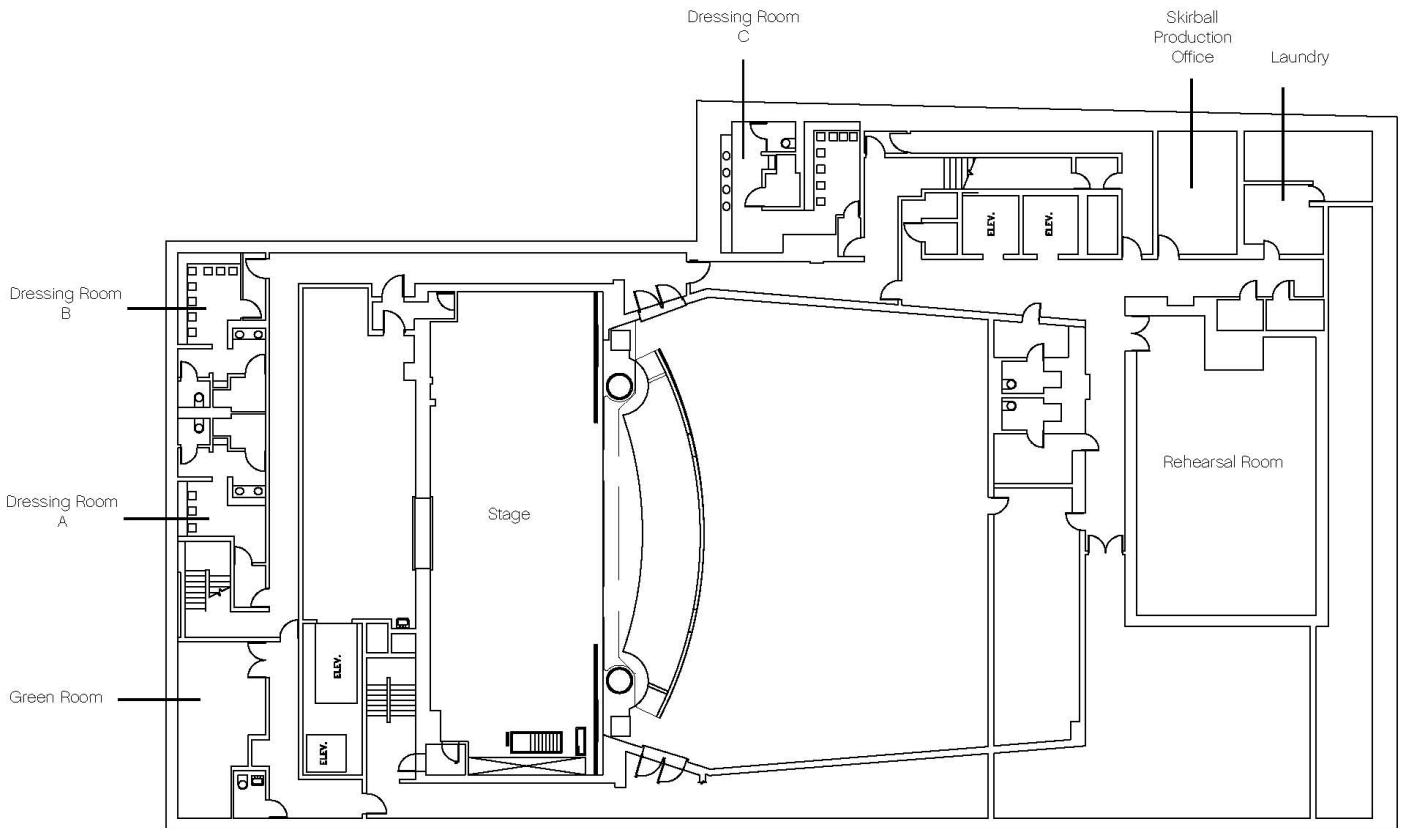

TECHNICAL DATA & INFORMATION

Jack H. Skirball Center for the Performing Arts

SEATING CHART

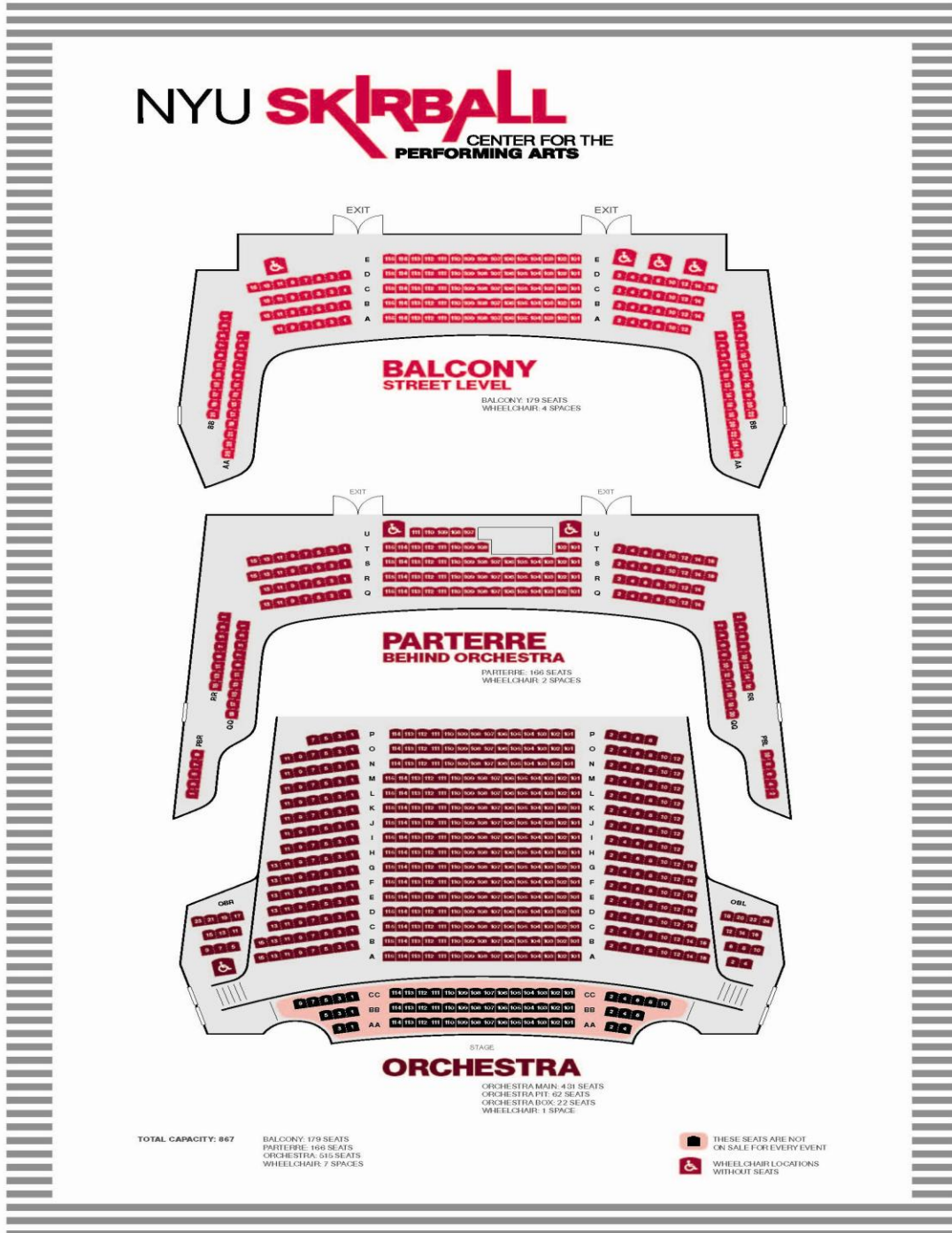

TECHNICAL DATA & INFORMATION

Jack H. Skirball Center for the Performing Arts

NEIGHBORHOOD INFORMATION

HOTELS

Minetta Street
9 Minetta Street
212.475.6952
Avg. nightly rate: \$139.95

Embassy Suites New York
102 North End Avenue
212.945.0100
Avg. nightly rate: \$279
embassysuites.com

Club Quarters
52 William St.
212.269.6400
Avg. nightly rate: \$259
clubquarters.com

60 Thompson
60 Thompson Street
212.431.0400
Avg. nightly rate: \$440
thompsonhotels.com

Mercer Hotel
147 Mercer & Prince Street
212.966.6060
Avg. nightly rate: \$525
mercerothel.com

Club Quarters
40 W 45th St.
212.354.6400
Avg. nightly rate: \$349
clubquarters.com

Washington Square Hotel
103 Waverly Place
212.777.9515
Avg. nightly rate: \$296
wshotel.com

Comfort Inn
136 Ludlow St.
212.260.4141
Avg. nightly rate: \$249
comfortinnlowereastside.com

Affinia Hotels
Various Locations
1.866.affinia
Avg. nightly rate: \$335
affinia.com

Candlewood Suites
21 2nd Street
201.659.2500
Avg. nightly rate: \$154
candlewoodsuites.com

Soho Grand
310 West Broadway
212.965.3000
Avg. nightly rate: \$385
sohogrand.com

Millenium Hilton
55 Church St.
212.693.2001
Avg. nightly rate: \$249
hilton.com

Holiday Inn Manhattan.Downtown/Soho
138 Lafayette Street
212.966.8898
Avg. nightly rate: \$359
hidowntown-nyc.com

Howard Johnson Express Inn
135 East Houston Street
212.358.8848
Avg. nightly rate: \$185
hojo.com

RESTAURANTS

DELICATESSEN

Gus and Us
178 MacDougal
212.995.0771

Space Market
1 University Pl.
212.677.0044

Campus Eatery
31 W 4th St.
212.475.3600

TECHNICAL DATA & INFORMATION

Jack H. Skirball Center for the Performing Arts

NEIGHBORHOOD INFORMATION cont.

AMERICAN

Cozy Soup'n Burger
739 Broadway
212.477.5566

Washington Square Diner
150 W 4th St. @ 6th Ave.
212.533.9306

Jane
100 W Houston St.
212.254.7000

Colors
417 Lafayette St # 1
212.777.8443

Silver Spurs
490 Laguardia Pl.
212.228.2333

North Square
103 Waverly Pl.
212.254.1200

INDIAN

The Kati
99 MacDougal St.
212.420.6497

Roll Company
90 W 3rd St.
212.529.5353

Baluchi's Masala Times
194 Bleecker St.
212.477.3333

ITALIAN

Patsy's
67 University Pl.
212.533.3500

Porto Bello
208 Thompson St.
212.473.7794

Babbo
110 Waverly Pl.
212.777.0303

Volare
147 W 4th St.
212.777.2849

Monte's
97 MacDougal St.
212.228.9194

Village Trattoria
135 W 3rd St.
212.598.0011

ASIAN

Cho Cho
15th W 8th St.
212.473.3333

San Dojo
14 W 4th St.
212.505.8934

Galanga
9 W 4th St.
212.228.4267

Apple
17 Waverly Pl.
212.473.8888

Cafetasia
38 E 8th St.
212.529.2363

Suzie's
163 Bleecker St.
212.777.1395

VEGETARIAN

Red Bamboo
140 W 4th St.
212.260.7049

Quantum
226 Thompson St.
212.677.8050

Leap Bite
335 Lafayette St.
212.431.0301

Sacred chow
227 Sullivan St. # 1
212.337.0863

Gobo
401 Avenue of the Americas
212.255.3242

TECHNICAL DATA & INFORMATION

Jack H. Skirball Center for the Performing Arts

NEIGHBORHOOD INFORMATION cont.

FAST FOOD

Chipotle
55 E 8th St.
212.982.3081

Johnny Rockets
42 E 8th St.
212.253.8175

Soup Man
2 Astor Pl.
212.228.4600

MEDITERRANEAN

Falafel Spot
15 Waverly Pl.
212.614.6960

Eva's
11 W 8th St.
212.677.3496

Hummus Place
99 MacDougal St.
212.533.3089

Mamoun's falafel
119 MacDougal St.
212.674.8685

Gus' Place
192 Bleecker St.
212.777.1660

Yatagan Kebab House
104 MacDougal St.
212.677.0952

COFFEE/TEA

Think Coffee, NYU Bookstore
726 Broadway
212.998.4667

Think Coffee
248 Mercer St.
212.228.6226

Caffe Reggio
119 MacDougal St.
212.475.9557

Tea Spot
127 MacDougal St.
212.832.7768

J&B Coffee and Tea
123 W 3rd St.
212.475.4859

Starbucks
79 Washington Sq E
212.995.3443

LATIN

Murphy & Gonzalez
23 Waverly Pl.
212.529.1500

Cuba
222 Thompson St.
212.420.7878

Florencia 13
185 Sullivan St.
212.677.6830

Panchito's
105 MacDougal St.
212.473.9278

Dos Caminos
475 W Broadway
212.277.4300

PIZZA

Otto
1 5th Ave
212.995.9559

Pizza Mercato
11 Waverly Pl.
212.420.8432

Two Boots to Go-Go
74 Bleecker St.
212.777.1033

Ben's Pizza
123 MacDougal St.
212.677.0976

Tre Giovani
548 Laguardia Pl.
212.475.7420

Famiglia Pizzeria
757 Broadway
212.353.2900

SANDWICHES

'Wichcraft
60 E 8th St.
212.780.0577

Au Bon Pain
684 Broadway #1
212.420.1694

Peanut Butter & Co.
240 Sullivan St.
212.677.3995

TECHNICAL DATA & INFORMATION

Jack H. Skirball Center for the Performing Arts

NEIGHBORHOOD INFORMATION cont.

DESSERT

Insomnia Cookies
50 W 8th St.
212.228.2373

Pinkberry
177 Bleecker St.
212.477.1810

Bruno Bakery
506 Laguardia Pl.
212.982.5854

BARS/TAVERNS/LOUNGES

Negril Village
70 W 3rd St.
212.477.2804

The Half Pint
76 W 3rd St.
212.260.1088

The Red Lion
151 Bleecker St.
212.260.9797

1849 Restaurant
183 Bleecker St.
212.505.3200

MacDougal Street Ale House
122 MacDougal St.
212.254.8569

Shade
241 Sullivan St.
212.982.6275

GENERAL STORES

Metro Drugs
13 E 8th St.
212.982.7325

Staples
390 Avenue of the Americas
212.673.1090

Walgreens
8 Astor Pl.
212.375.0734

Duane Reade
4 W 4th St.
212.473.1027

Duane Reade
144 Bleecker St. # 2
917.534.1370

Kmart
770 Broadway
212.253.9661

SUPERMARKETS

Gristede's
246 Mercer St.
212.777.9498

Morton Williams
130 Bleecker St.
212.358.9597

Whole Foods
95 E Houston St.
212.420.1320

BANKS

Citibank
555 Laguardia Pl.
212.387.7270

HSBC
354 6th Avenue
212.292.1423

Chase
26 Astor Pl.
212.935.9935

Bank of America
770 Broadway
212.253.2718

TD Bank
666 Broadway
212.354.6061

TECHNICAL DATA & INFORMATION

Jack H. Skirball Center for the Performing Arts

NEIGHBORHOOD INFORMATION cont.

DRY CLEANERS

Campus Laundry & Cleaners Inc.
146 W 4th St.
212.677.9933

Best Cleaner
215 Thompson St.
212.473.0053

Swan's NYC Cleaners Inc.
542 LaGuardia Pl.
212.673.1032

HARDWARE

Ace Hardware
125 W 3rd St.
212.777.1500

Shapiro Hardware
63 Bleecker St.
212.477.4180

T S Hardware
52 E 8th St.
212.477.2999

COPY CENTERS

NYU Copy Central
547 Laguardia Pl.
212.998.1050

Advanced Copy Center Inc.
552 Laguardia Pl.
212.399.1001

FedEx/Kinko's
21 Astor Pl.
212.228.9511

FUEL

Houston Service Station
21 E Houston
212.220.4216

Sunny's 7 Eleven Inc.
103 W 14th St.
212.229.0711

PARKING GARAGES

Minetta's Garage
122 W 3rd St.
212.777.3530

Brevoort Parking
12-20 E 9th St.
212.473.9751

Key Parking
115 E 9th St.
212.473.9643

NYU Village Garage
60 W 3rd St.
212.253.9061

DW Valet & Concierge Services Inc.
91 Bleecker St.
212.254.6214

Edison Parking
375 Lafayette St.
212.253.6950

Champion Broadway Parking
60 E 8th St.
21.2.473.9061

8th St. Parking Corporation
11 5th Ave.
212.475.9562

Mercer Parking
165 Mercer St.
212.226.5578

NYC TAXI CABS

Cabs can be hailed from the street. Look for the on duty light on top of the cab. Taxi rates are clearly labeled on the outside door of cab. A meter is generally mounted on the front dash of the car. Rates start at \$2.50 and then the meter starts to run based on distance and time standing still. You may request a printed receipt.

TECHNICAL DATA & INFORMATION

Jack H. Skirball Center for the Performing Arts

MAPS

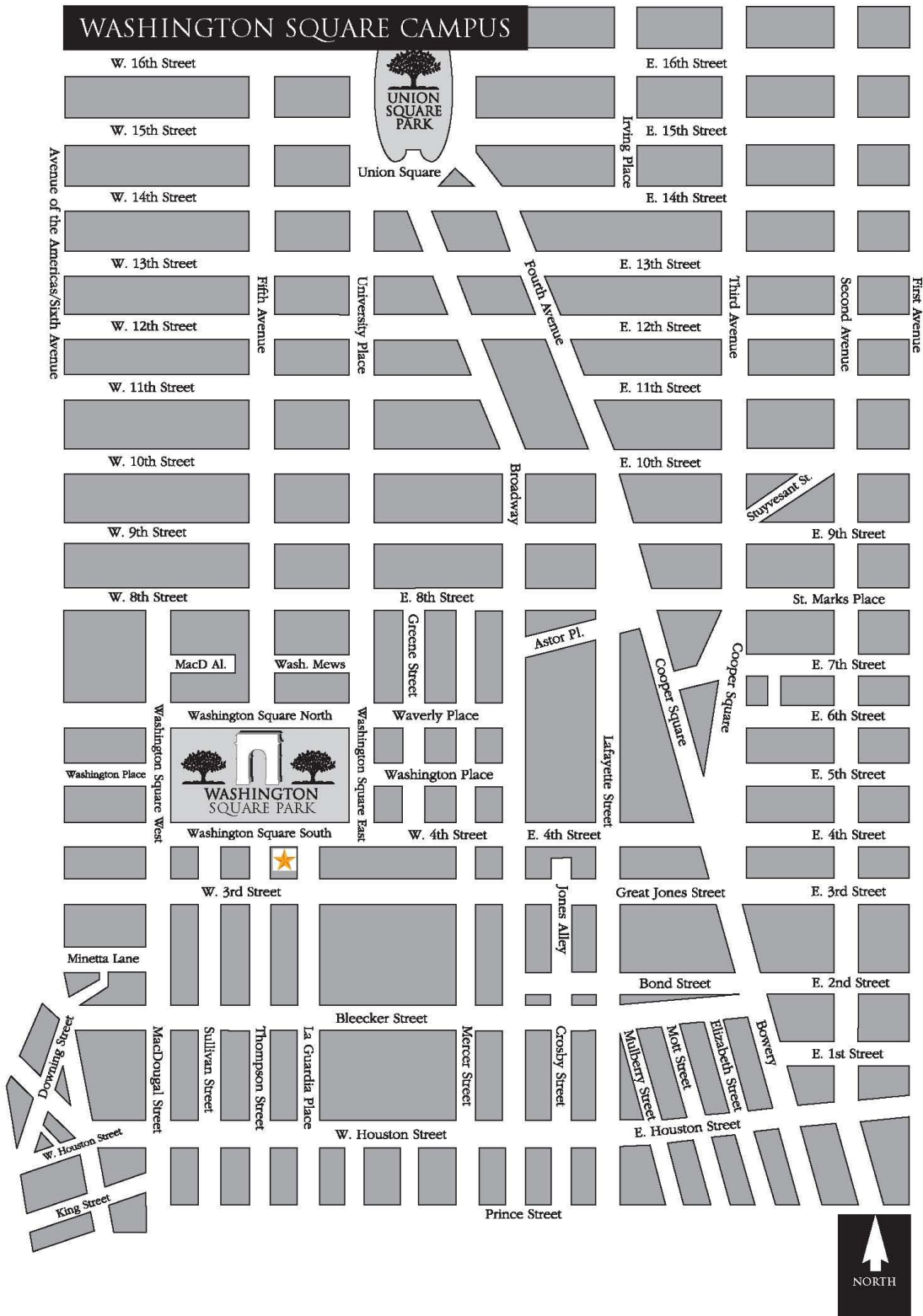

TECHNICAL DATA & INFORMATION

Jack H. Skirball Center for the Performing Arts

SUBWAY

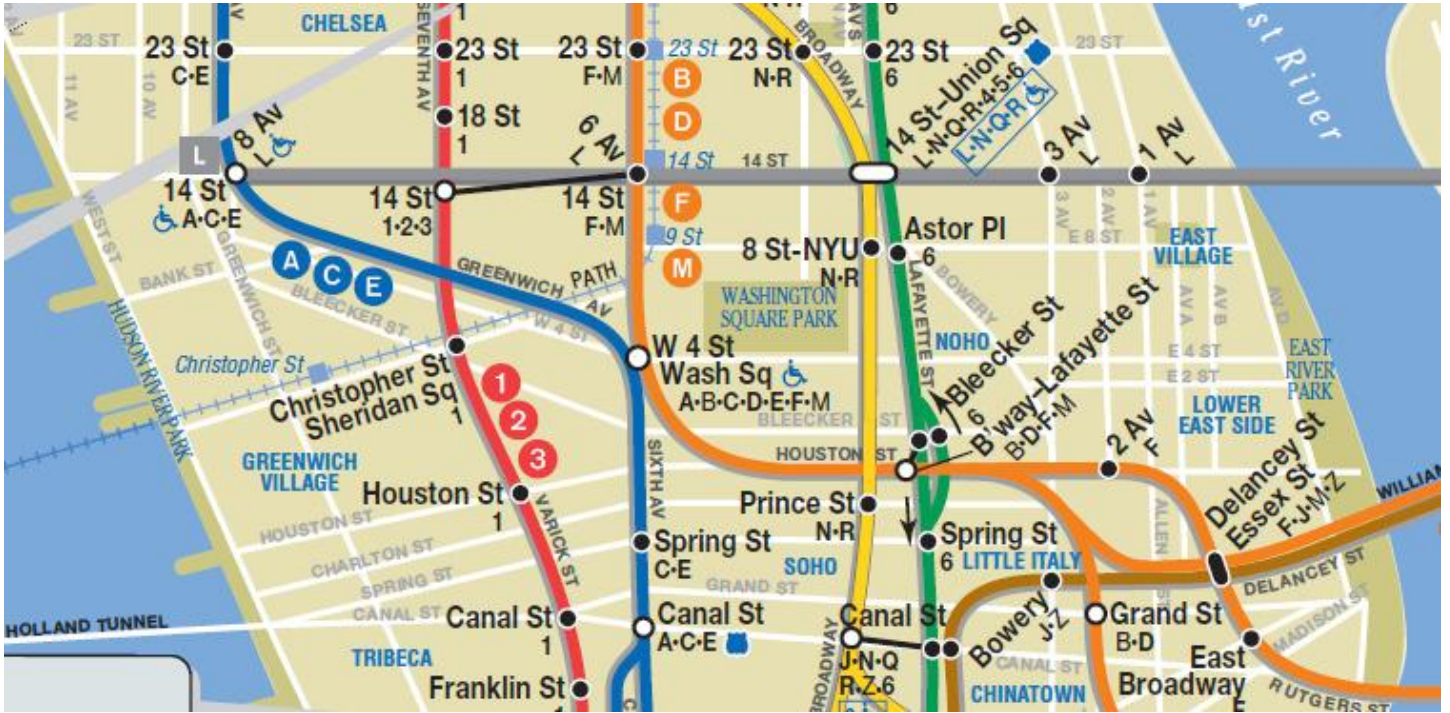

BUS

